

Installing S618 Mesh Node

Self-Configuring Outdoor Wifi Radio
Instruction Manual

What's Inside the Box

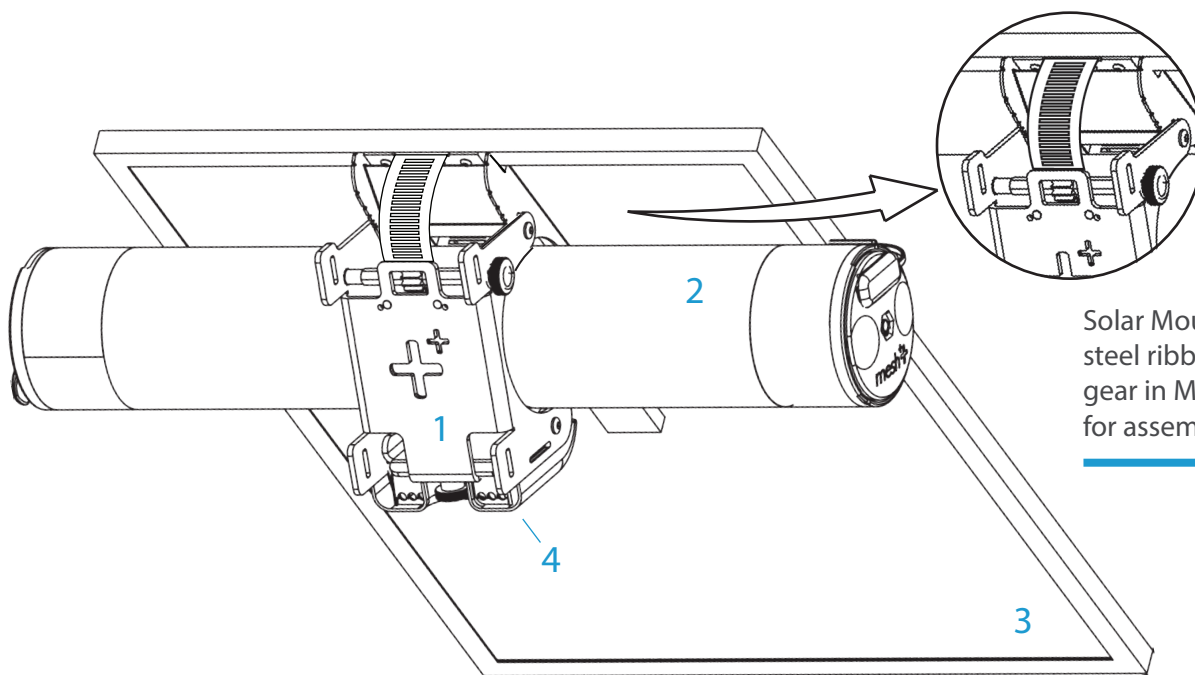

Solar Mount Assembly. Spring steel ribbon and angle adjustment gear in Main Mount. Scan for assembly instructions.

S618 Mesh Node

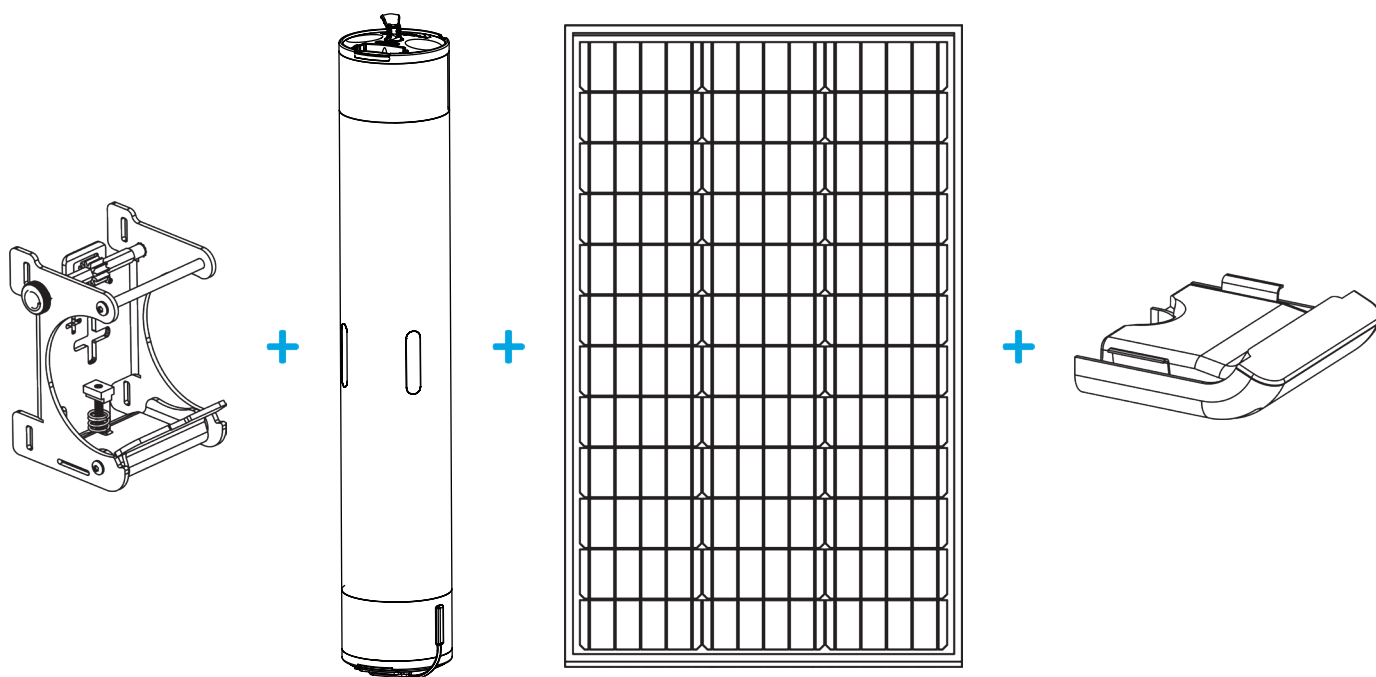

1 - Main Mount

2 - Component Tube

3 - Solar Panel

4 - USB Splitter

Assembling Solar Panel

A Remove 6 M3 bolts from solar panel frame

B Sandwich spring steel ribbon between solar panel frame and solar panel mount

C Replace 6 M3 bolts into original positions in solar panel frame

3 Solar Panel Assembly

D The Solar Panel Assembly is now ready to attach to main mount in step 6 of [Installation](#) on next page

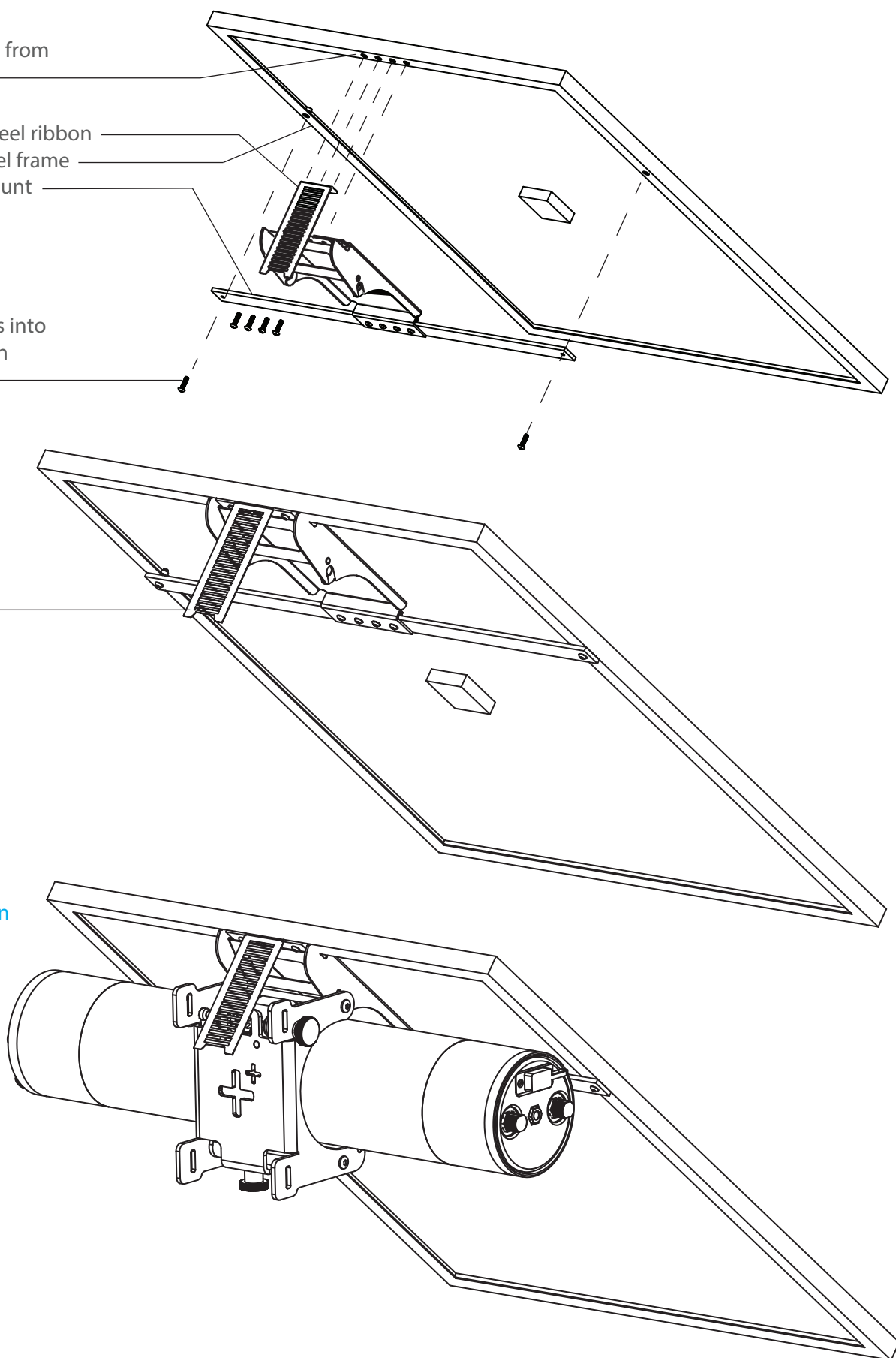

Installation

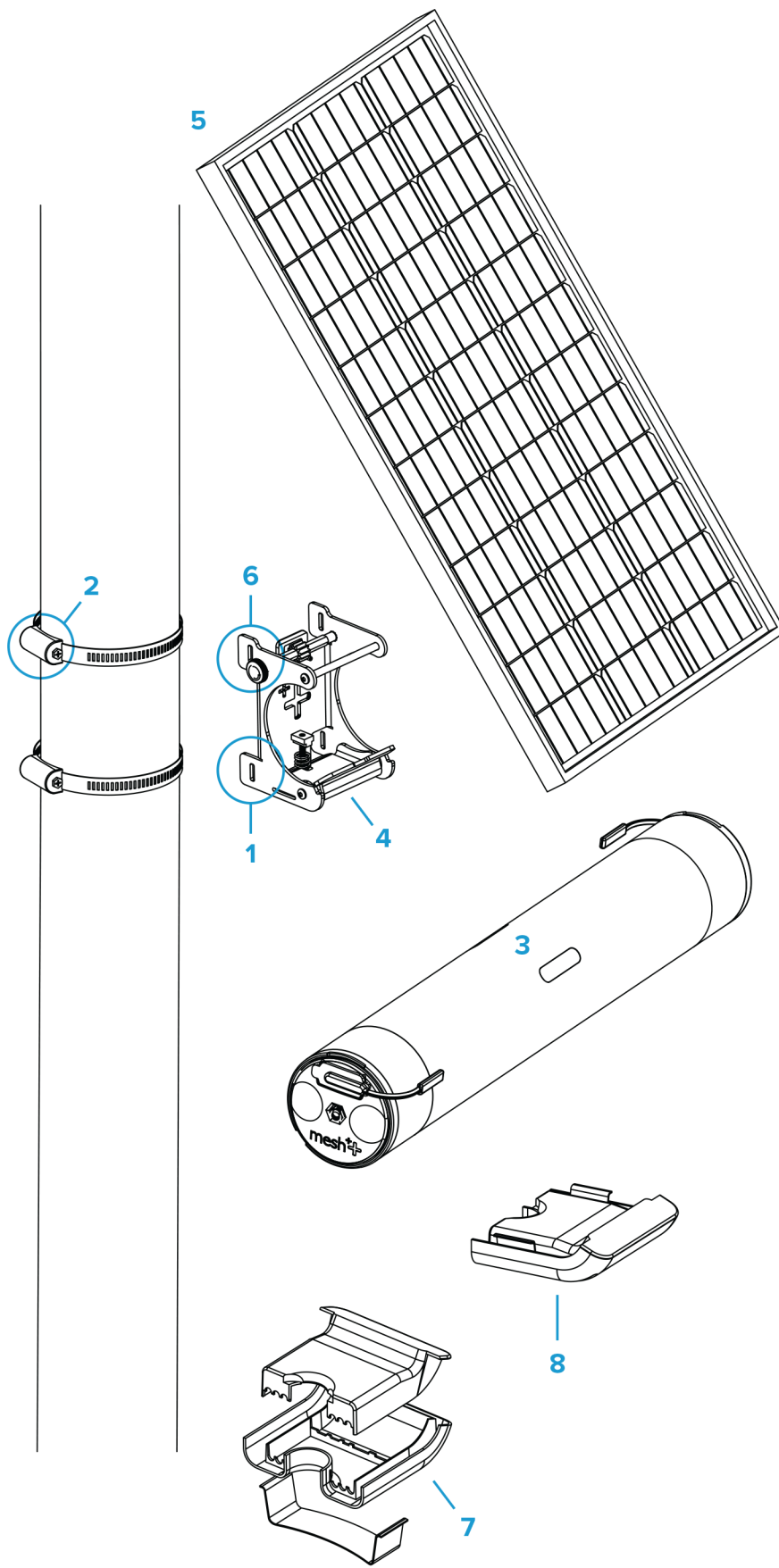

- 1 Thread adjustable hose clamps though eyelets in **Main Mount**.
- 2 Affix hose clamps securely to sturdy pole. Has to support up to 17 lbs.
- 3 Place S618 Node Assembly **Component Tube** into cradle of Main Mount in proper position, imprint recessed area to line up with mount on bottom, logos on End Seal Plates horizontal, right reading. Make sure enclosure is tight and can't be moved within the mount.
- 4 Tighten metal mount clamp to S618 Node with turn knob on bottom of Main Mount.
- 5 Attach **Solar Panel** Arm to top of Main Mount. Plug in solar power cable to connector on End Seal Plate.
- 6 Thread spring steel ribbon through angle adjustment gear, pulling and turning angle adjustment knob on either side of Main Mount. **Please research the optimal angle for sunlight based on your latitude.**
- 7 (Optional) Plug in usb-a, usb-c, ethernet cable or memory stick into USB Splitter Housing Top as desired.
- 8 Snap into **USB Splitter** Housing Bottom and clip into bottom horizontal slots on both sides of Main Mount.

Set Up Connectivity

1

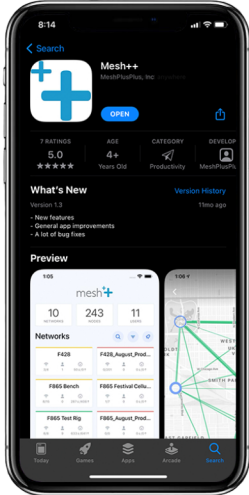

Open the Mesh++ App for setup

2

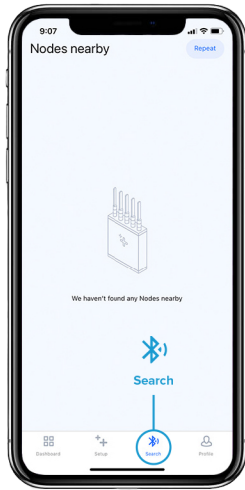

Tap  **Search** in the Mesh++ App

3

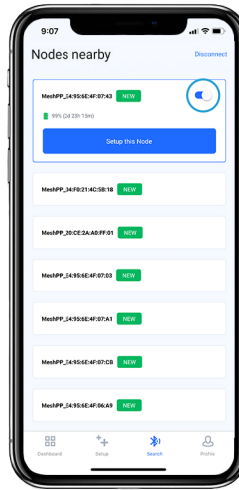

Tap the node in the app, and turn it on via its **ON/OFF toggle** on the right side

4

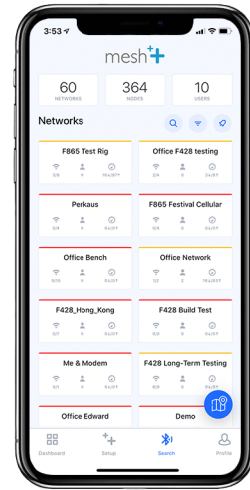

Configure as needed and connect to WiFi

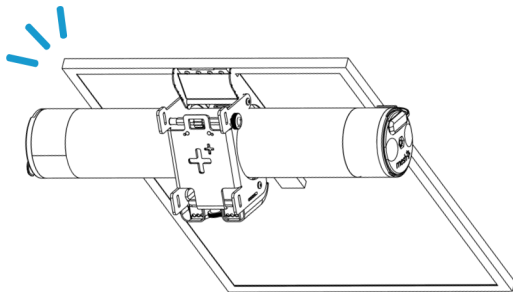

Congratulations!

Your S618 Mesh Node is now set up and ready to help you take the internet anywhere.



Disclaimer

MESHPLUSPLUS INC. MAKES NO WARRANTY OF ANY KIND WITH REGARD TO THIS MATERIAL, INCLUDING, BUT NOT LIMITED TO, THE IMPLIED WARRANTIES OF MERCHANTABILITY AND FITNESS FOR A PARTICULAR PURPOSE. MeshPlusPlus, Inc. shall not be liable for errors contained herein or for incidental or consequential damages in connection with the furnishing, performance, or use of this material. Nothing herein should be construed as constituting an additional warranty. MeshPlusPlus, Inc. shall not be liable for technical or editorial errors or omissions contained herein. MeshPlusPlus, Inc. assumes no responsibility for the use or reliability of its equipment. THIS PRODUCT HAS NOT BEEN CERTIFIED BY THE FEDERAL COMMUNICATIONS COMMISSION, ALTHOUGH INDEPENDENTLY VERIFIED TO BE COMPLIANT AS A CLASS B ELECTRONIC DEVICE. 5.15-5.25GHZ OPERATION IS LIMITED TO INDOOR APPLICATIONS ONLY. THIS PRODUCT MAY NOT BE USED FOR UNLAWFUL PURPOSES AND THAT USE IS EXPRESSLY PROHIBITED UNDER THE TERMS AND CONDITIONS OF ITS USE.

© Copyright 2021 MeshPlusPlus, Inc. The information contained herein is subject to change without notice.

This document contains proprietary information, which is protected by copyright. No part of this document may be photocopied, reproduced, or translated into another language without the prior written consent of MeshPlusPlus, Inc.

S618 Wiring Diagram

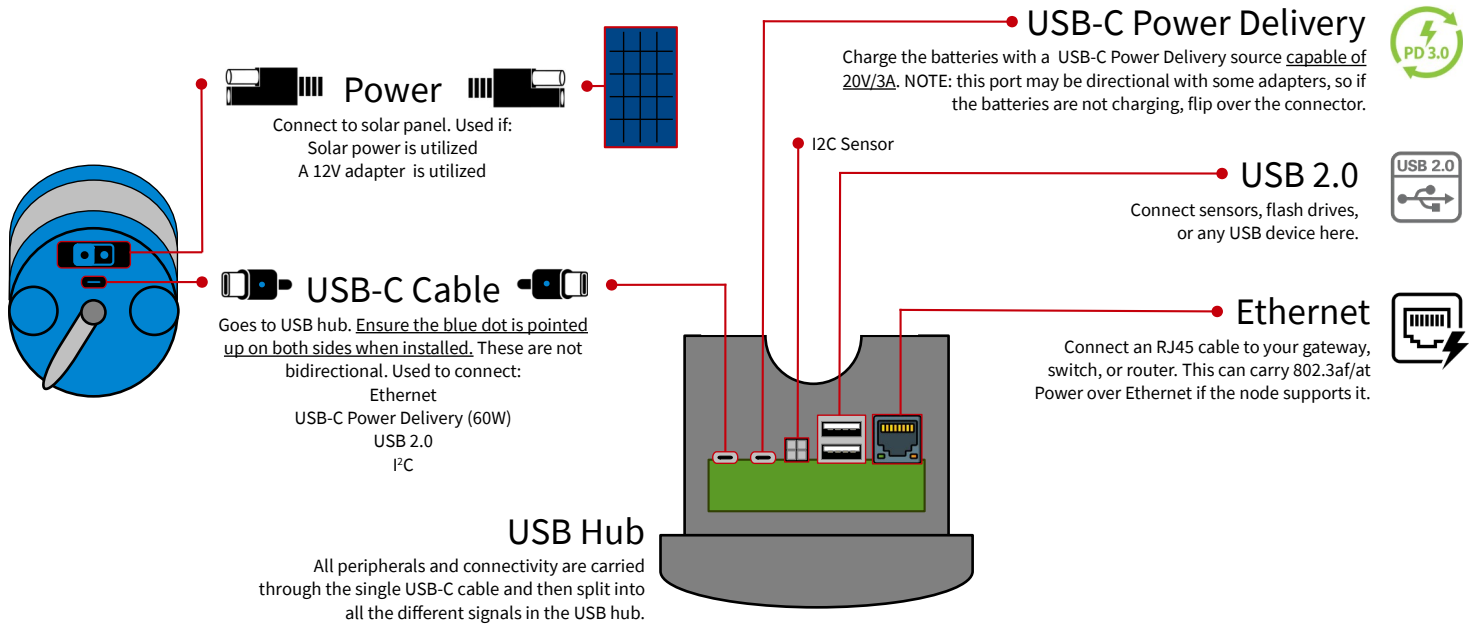

Typical configuration: PoE gateway

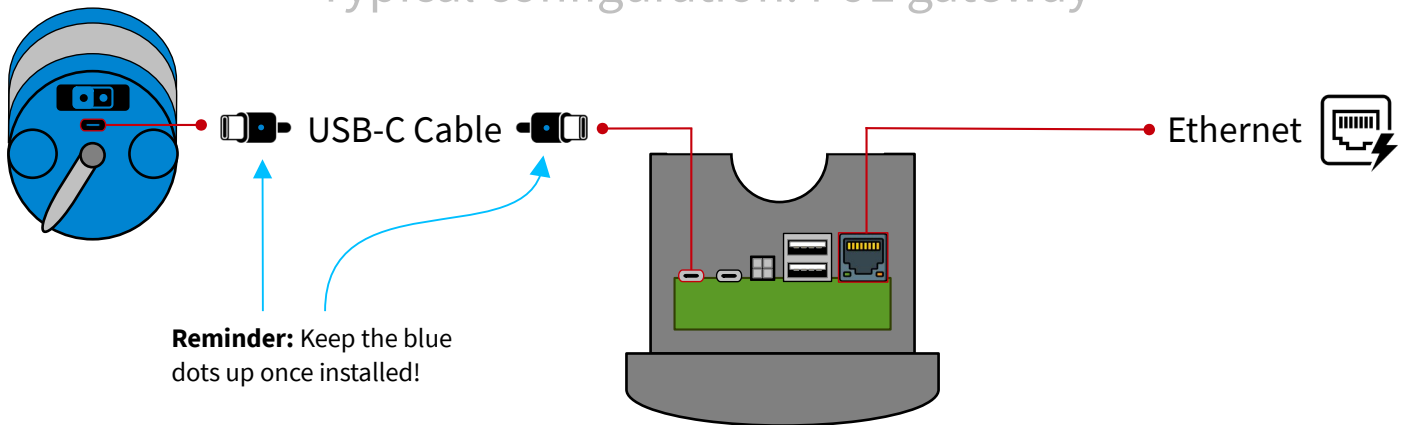

Typical configuration: Solar mesh node

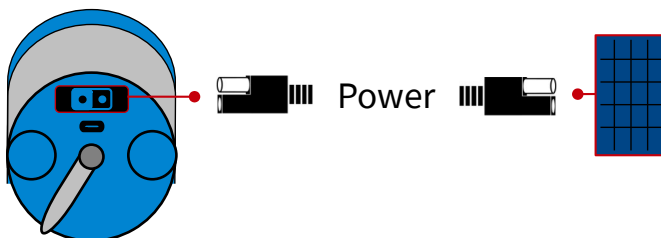

MESHPLUSPLUS INC. MAKES NO WARRANTY OF ANY KIND WITH REGARD TO THIS MATERIAL, INCLUDING, BUT NOT LIMITED TO, THE IMPLIED WARRANTIES OF MERCHANTABILITY AND FITNESS FOR A PARTICULAR PURPOSE. MeshPlusPlus, Inc. shall not be liable for errors contained herein or for incidental or consequential damages in connection with the furnishing, performance, or use of this material. Nothing herein should be construed as constituting an additional warranty. MeshPlusPlus, Inc. shall not be liable for technical or editorial errors or omissions contained herein. MeshPlusPlus, Inc. assumes no responsibility for the use or reliability of its equipment. THIS PRODUCT HAS NOT BEEN CERTIFIED BY THE FEDERAL COMMUNICATIONS COMMISSION, ALTHOUGH INDEPENDENTLY VERIFIED TO BE COMPLIANT AS A CLASS B ELECTRONIC DEVICE. 5.15-5.25GHZ OPERATION IS LIMITED TO INDOOR APPLICATIONS ONLY. THIS PRODUCT MAY NOT BE USED FOR UNLAWFUL PURPOSES AND THAT USE IS EXPRESSLY PROHIBITED UNDER THE TERMS AND CONDITIONS OF ITS USE.

© Copyright 2021 MeshPlusPlus, Inc. The information contained herein is subject to change without notice. This document contains proprietary information, which is protected by copyright. No part of this document may be photocopied, reproduced, or translated into another language.

mesh⁺